



TP-E219

VIVE Comfort
1111 S. Glenstone Ave., Suite 2-100
Springfield, MO 65804

Toll-Free: 1-800-776-1635 Web: www.vivecomfort.com
Hours of Operation: M-F 9AM - 6PM Eastern



Application Guide

The TP-E219 is an optional accessory to TP-WCTO (Wireless Wire.) When TP_WCTO is installed outdoors, it must be weather protected. The TP-E219 is a weather resistant junction box that can be used to weather protect TP-WCTO.

Table of Contents

	Page
Installation Tips	2

A trained, experienced technician must install this product.

Carefully read these instructions. You could damage this product or cause a hazardous condition if you fail to follow these instructions.

Una versión en español de este manual se puede descargar en la página web de la compañía.

Features:

- Non-metallic junction box
- UL Listed with a NEMA 6P rating per Section 314, exception of the National Electrical Code
- Manufactured from PVC or PPO thermoplastic molding compound and featuring foam-in-place gasket lids attached with stainless steel screws.

Dimensions (inches):

Width = 6"

Height = 6"

Depth = 4"

Includes:

- 4 Stainless steel screws for lid
- Rubber grommets for 3, 5, or 8 wire holes

Steps to mounting WW160W in E219 Junction Box:

- Mount the base plate of WW160W output module to the bottom of junction box.
- Drill hole big enough for thermostat wire or rubber grommet (rubber grommet may provide greater weather resistant seal)
- Feed thermostat wire through hole and connect to appropriate terminals (see WW160W instruction manual for wiring instructions)
- Plug WW160W into subbase
- Screw lid tightly onto E219
- Mount or place E219 where appropriate

Optional rubber grommets

3 wire

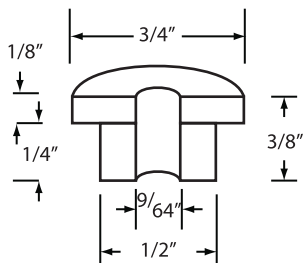

5 wire

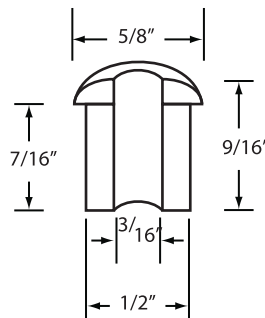

8 wire

